



30 Orrest Drive Flats, Windermere
£150,000





30 Orrest Drive Flats

Windermere

A well proportioned second floor apartment occupying a position in this popular residential location close to the village with fine views to the front. Location within the Lake District National Park being convenient for all the local amenities on offer in Windermere village and offering easy access to the railway station.

Introducing this 2 bedroom apartment nestled on the second floor of a peaceful building, boasting double glazing and gas central heating throughout for comfortable living. The property offers a light and airy sitting room providing far-reaching views, creating a serene ambience. The well-appointed kitchen features integrated appliances, enhancing convenience for daily living. Local occupancy regulations apply, adding an exclusive touch to this inviting abode. The two bedrooms, one being a spacious double, ensure ample space for relaxation. The three-piece suite bathroom completes the interior, exuding a sense of modernity and comfort. Permit parking adds to the convenience, ensuring hassle-free parking arrangements for residents. Further complementing the property is the outdoor storage space conveniently located at the rear, offering practical storage solutions.

- Second floor apartment
- Double glazing and gas central heating throughout
- Light and airy sitting room with far reaching views
- Located in the heart of the Lake District National Park
- Kitchen with integrated appliances
- Local occupancy applies
- Two bedrooms with one being a double
- Outdoor storage located to the rear of the property
- Three piece suite bathroom
- Permit parking applies

EPC RATING C

SERVICES

Mains electric, mains gas, mains water, mains drainage

COUNCIL TAX: BAND B

TENURE: LEASEHOLD

DIRECTIONS

From our Windermere office turn left in to Oak Street and take the second left in to Orrest Drive bearing left to find number 30 on the right.

WHAT3WORDS: soothing.pats.fear





SECOND FLOOR

ENTRANCE HALL

3' 7" x 3' 5" (1.10m x 1.05m)

SITTING ROOM

17' 5" x 10' 2" (5.30m x 3.10m)

KITCHEN

11' 7" x 6' 3" (3.53m x 1.91m)

INNER HALLWAY

4' 7" x 3' 7" (1.39m x 1.08m)

BEDROOM

13' 3" x 9' 1" (4.05m x 2.76m)

BEDROOM

10' 6" x 6' 5" (3.19m x 1.96m)

BATHROOM

6' 1" x 5' 7" (1.86m x 1.69m)









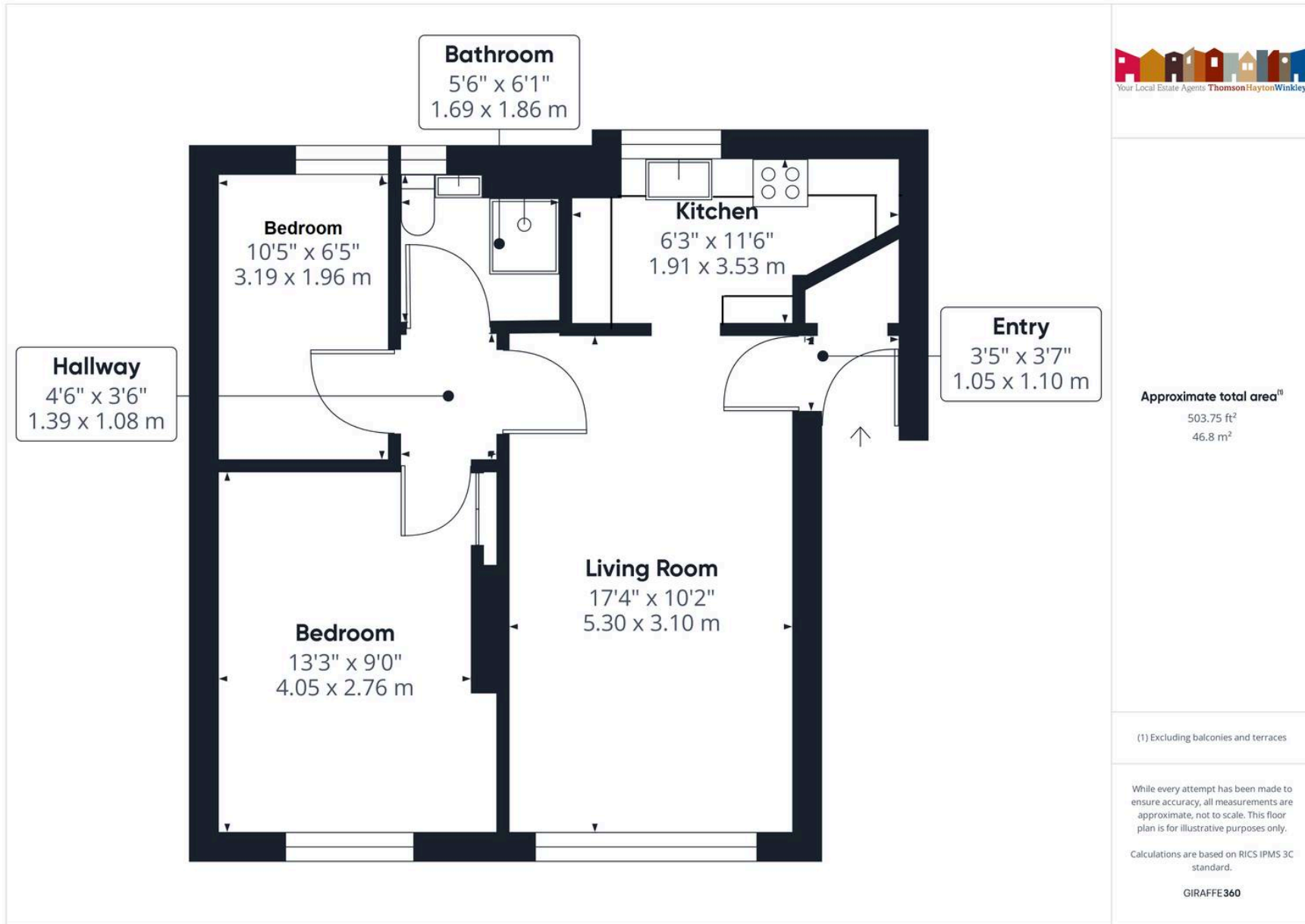

THW Estate Agents

25b Crescent Road, Windermere - LA23 1BJ

015394 47825 • windermere@thwestateagents.co.uk • www.thwestateagents.co.uk

Please note that descriptions, photographs and plans are for guidance only. Services and appliances have not been tested, measurements are approximate and alterations may not have necessary consents. Contact us for property availability and important details before travelling or viewing properties. THW Estate Agents Ltd is a separate legal entity to the solicitor firm of THW Legal Ltd which has different ownership and clients of THW Estate Agents Ltd do not have the same protection as those of THW Legal Ltd.