



## Waterhead Farm Barn & Orchard, Coniston, Coniston

Guide Price £430,000



## Waterhead Farm Barn & Orchard, Coniston

Coniston

GUIDE PRICE £430,000+

FOR SALE BY AUCTION ON THURSDAY 13TH  
FEBRUARY 2025 AT THE HALSTON CARLISLE 12  
NOON

Full details and bidding information at  
[auctionhousecumbria.co.uk](http://auctionhousecumbria.co.uk)

Lake District Development with planning for Four dwellings

Situated half a mile from the popular Lake District village of Coniston this Barn & Orchard has planning for FOUR dwellings.

The site is perfectly positioned for easy access to the attractions and amenities across the Lake District National Park and only a stones throw away from Lake Coniston. Coniston village benefits from cafes, restaurants, Church and Schools. Excellent Development Opportunity.

**Planning Reference 7/2023/5304** Full Planning for conversion of the barn into two dwelling with local occupancy restrictions.

Outline Planning for the erection of one detached dwelling with local occupancy restriction.

**Planning Reference 7/2024/5197** Outline Planning for the erection of an additional detached dwelling with local occupancy restriction

**Planning Information** Further information and documents can be found on the Lake District National Park planning portal.

Decision Notices and Site Plans can be found in the legal pack.

- Barn & Orchard has planning for FOUR dwellings.
- Perfectly positioned for easy access to the attractions and amenities
- Full Planning for conversion of the barn into two dwelling with local occupancy restrictions.
- Stones throw away from Lake Coniston
- Outline Planning for the erection of an additional detached dwelling with local occupancy restriction
- Excellent Development Opportunity
- For sale by auction on Thursday the 13th of February at the Halston in Carlisle at 12 noon
- In the heart of the Lake District National Park
- Stunning views of the local countryside











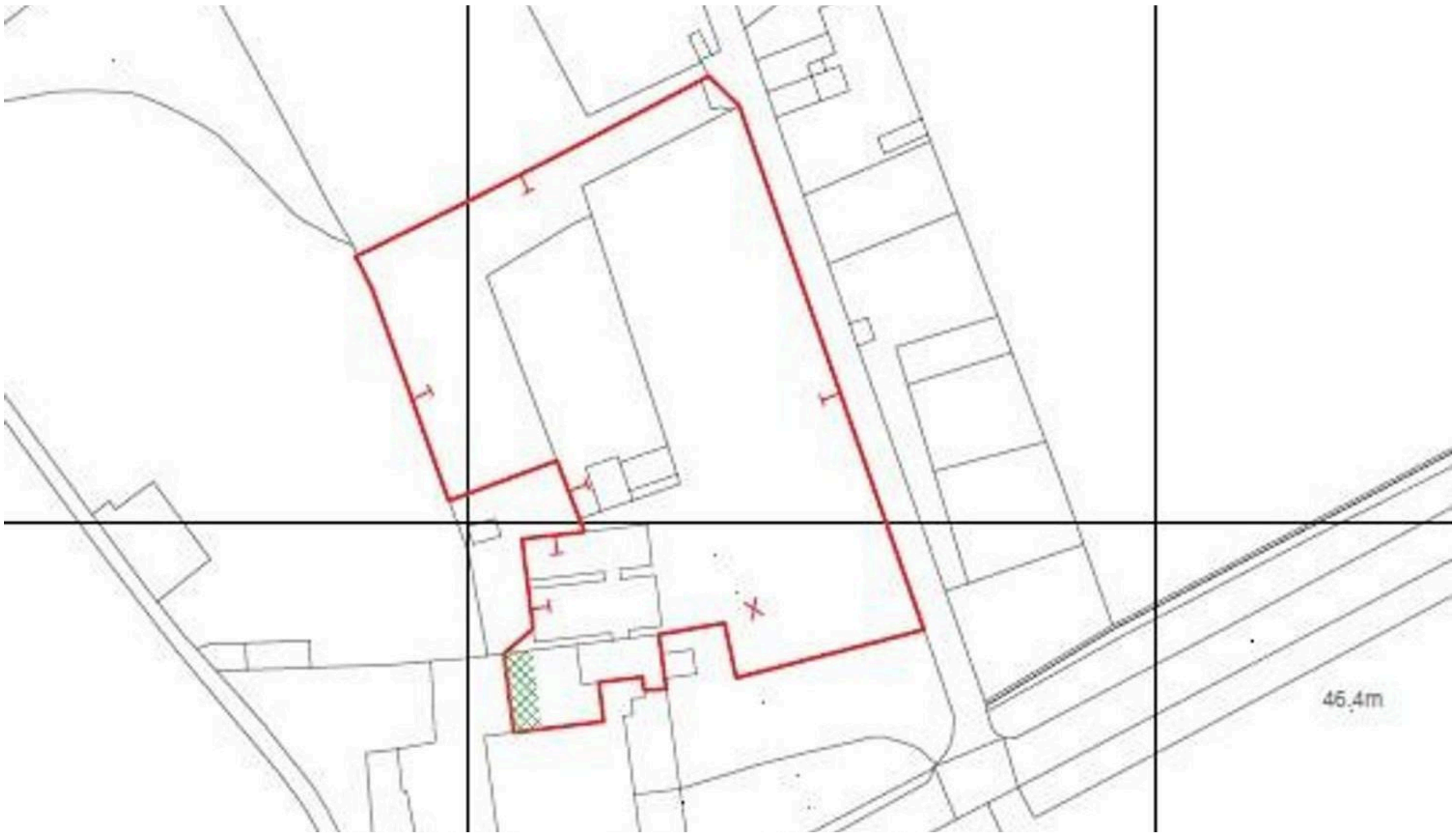

## THW Estate Agents

25b Crescent Road, Windermere - LA23 1BJ

015394 47825 • [windermere@thwestateagents.co.uk](mailto:windermere@thwestateagents.co.uk) • [www.thwestateagents.co.uk](http://www.thwestateagents.co.uk)

Please note that descriptions, photographs and plans are for guidance only. Services and appliances have not been tested, measurements are approximate and alterations may not have necessary consents. Contact us for property availability and important details before travelling or viewing properties. THW Estate Agents Ltd is a separate legal entity to the solicitor firm of THW Legal Ltd which has different ownership and clients of THW Estate Agents Ltd do not have the same protection as those of THW Legal Ltd.